

SW-SD *Wireless scoreboard display*



Features and benefits:

- Easy to read 100mm /4" LED display
- Rugged steel case
- Wall mount brackets supplied
- External antennae for maximum range
- Wide range for power supply input

This 100mm (4") scoreboard LED display is wireless and viewable for up to 45m/150ft.

Perfect for installation on a crane gantry, the unit operates on 110-240 VAC and displays an individual load or summed load for up to eight Straightpoint wireless devices.

Solution

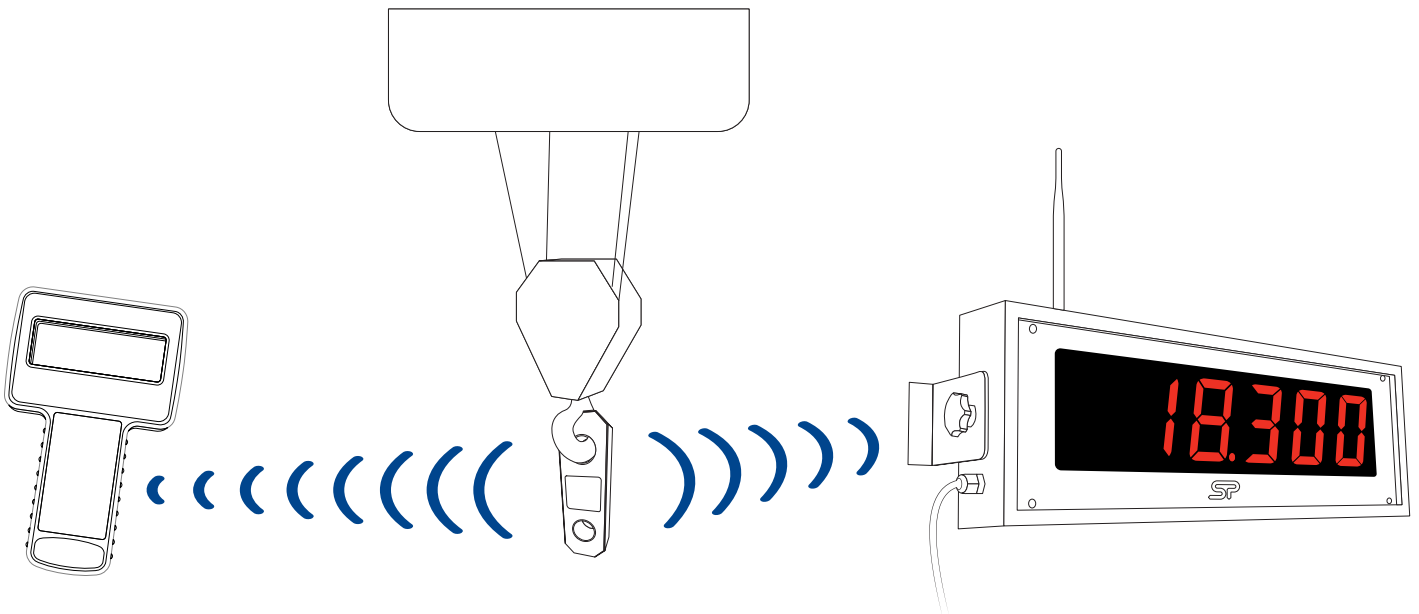

Parameter	Minimum	Typical	Maximum	Units
External supply voltage range	110	240	250	Volts AC
Average operational current	-	1A	3.5A peak	mA
Operating temperature range	-20°C (-4°F)	-	65°C (149°F)	°C (°F)
Storage temperature range	-20°C (-4°F)	-	65°C (149°F)	°C (°F)
Range	700m / 2300ft			



making the lifting industry a safer place